

FUNSKOOL

3+

# FARM SET



FRONT

## INSTRUCTIONS

The Ultimate Farm themed playset with Fundough!  
Custom build your own farm with trees, crops, tractor, animals, scarecrow and much more..

### CONTENTS:

- Farm house body -1 unit.
- Farm house roof (with chimney) - 1 no.
- Windows - 4 nos. (Diamond, circle, cross & flower shaped hole)
- Rake - 1 no.
- Shovel - 1 no.
- Animal moulds (Sheep, horse, cow, pig) - 4 nos.
- Farm gate and wall column (to be assembled) - 1 no. each.
- Fence cutter - 1 no.
- Tree branches - 3 nos.
- Tractor - 1 no.
- Plough - 1 no.
- Farmer (with footprint roller) - 1 no.
- Milk can cutters (apple, lemon, carrot) - 3 nos.
- Scarecrow (head, legs, right & left hand) - 4 parts
- Dog stamp - 1 no.
- Chicken stamp - 1 no.
- Fundough tubs - 125 g each - 4 nos.

### USING THE FARM HOUSE EXTRUDER:

Affix the 4 windows on to the respective matching shapes given on the sides of the farm house body unit. Choose any one of the window shapes and insert it on the slot provided on the chimney on the roof.

Make a suitable sized ball of dough and place it on top of the farm house body unit. (Refer Fig. 1) Now, push the roof through the projection on the farm house body unit. Notice, how the dough gets extruded from the chimney (much like smoke). To cut the dough to the desired length, pull out the window from the slot.

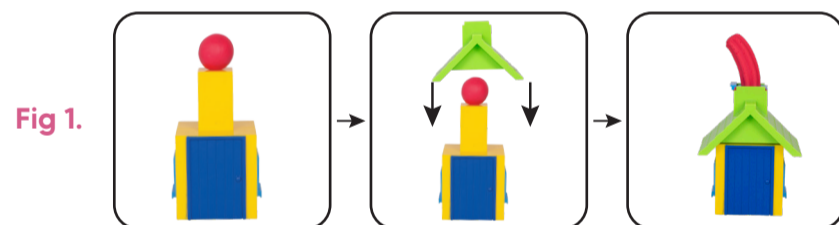

### USING THE ANIMAL MOULDS:

There are four animal moulds provided with this kit - Sheep, Pig, Horse and Cow. Take a ball of suitable sized dough and place it in the animal mould of your choice. Close the mould tightly for a few seconds. Remove the excess dough from the sides, if any. Now, open the mould to reveal your moulded animal. (Refer Fig. 2)

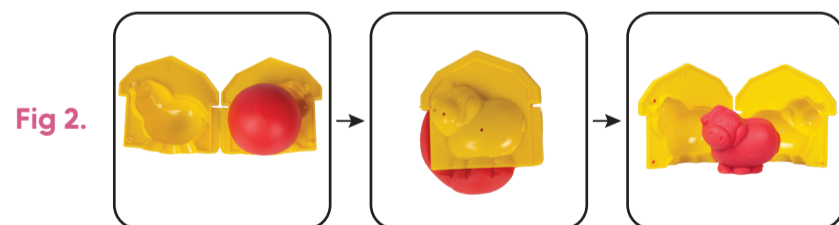

### USING THE FENCE CUTTER:

Press the fence cutter on flattened out dough. Remove the excess dough from all the sides, if any. Lift the fence cutter to reveal your formed fence. Create a series of fences and place it all around your farm scene. (Refer Fig. 3)

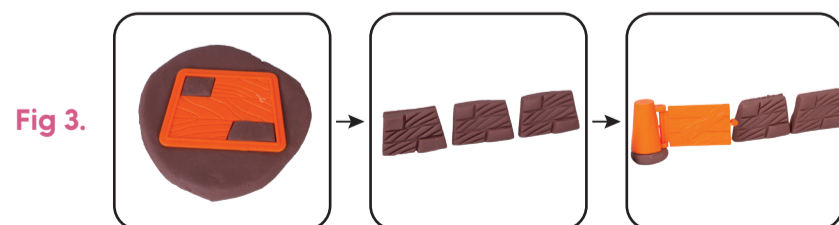

BACK

### USING THE PLOUGH & THE FARMER (WITH FOOT PRINT ROLLER):

The plough and the farmer can be rolled on flattened dough to create plough lines and footprints respectively on the dough. (Refer Fig. 4)

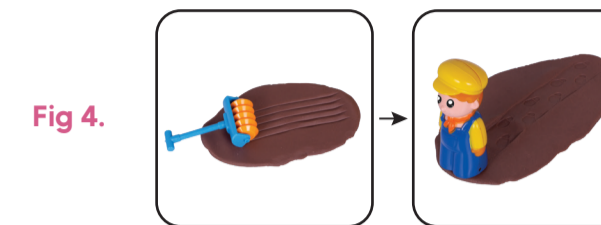

### BUILDING A SCARECROW:

The scarecrow has four parts - Head, legs, right hand and left hand. First, shape a ball of dough in the form of a body and insert the head, legs and hands to form a complete scarecrow. (Refer Fig. 5)

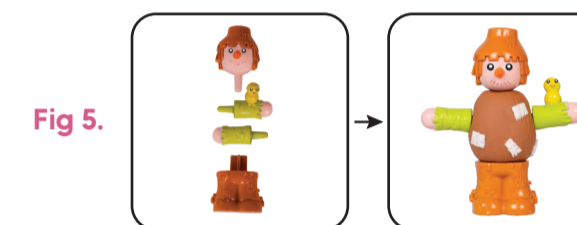

### MAKING TREES AND FARM PRODUCE:

There are three tree branches provided in this kit. Shape the dough in the form of balls of different sizes and add them to the branches of the trees. You could then use the milk can cutters to cut different types of produce (carrot, apple and lemon) and add it to your trees / farm. (Refer Fig. 6)

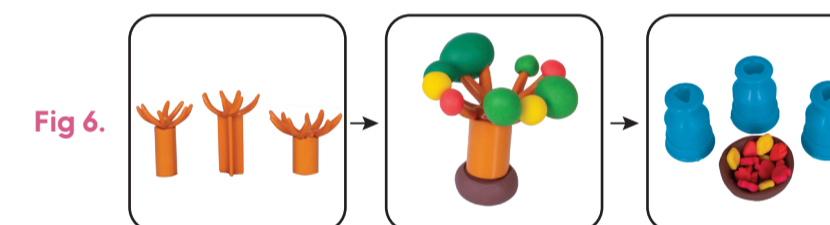

### INSTALLING THE GATE TO YOUR FARM:

Fit the farm gate into the wall column provided as shown. Make a small ball of dough and fix the gate column on the ball and place it between any two fences. (Refer Fig. 7)

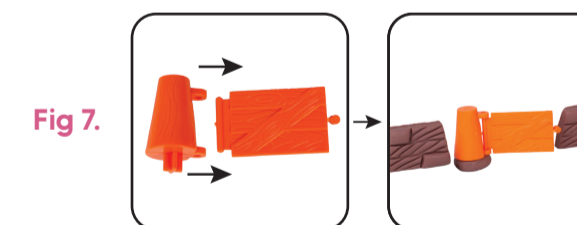

### USING THE ANIMAL STAMPS:

The dog and the chicken stamp can be used to create impressions on flat dough surfaces. (Refer Fig.8)

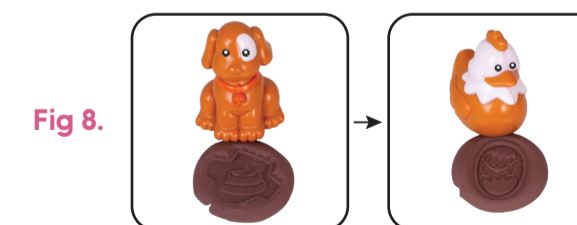

**NOW, YOU ARE ALL SET FOR A FUN, FARM THEMED PLAYDAY!**